

REFERENCE DRAWINGS		
NUMBER	DRAWING TITLE	REMARKS

Plot Scale 1 : 1
 Project On 04-05-2011:3
 Revision R1
 Status Final

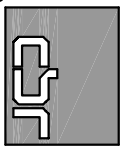

CSR Consultants

- ARCHITECTURE
- ENGINEERING
- INTERIOR DESIGN
- PLANNING

OFF: CG 9 & 10, CELLAR FLOOR,
 VIJAYA HILLS APPTS. A.C. Guards
 HYDERABAD - 500 004, A.P.
 PHONES : 23391889, 23322045

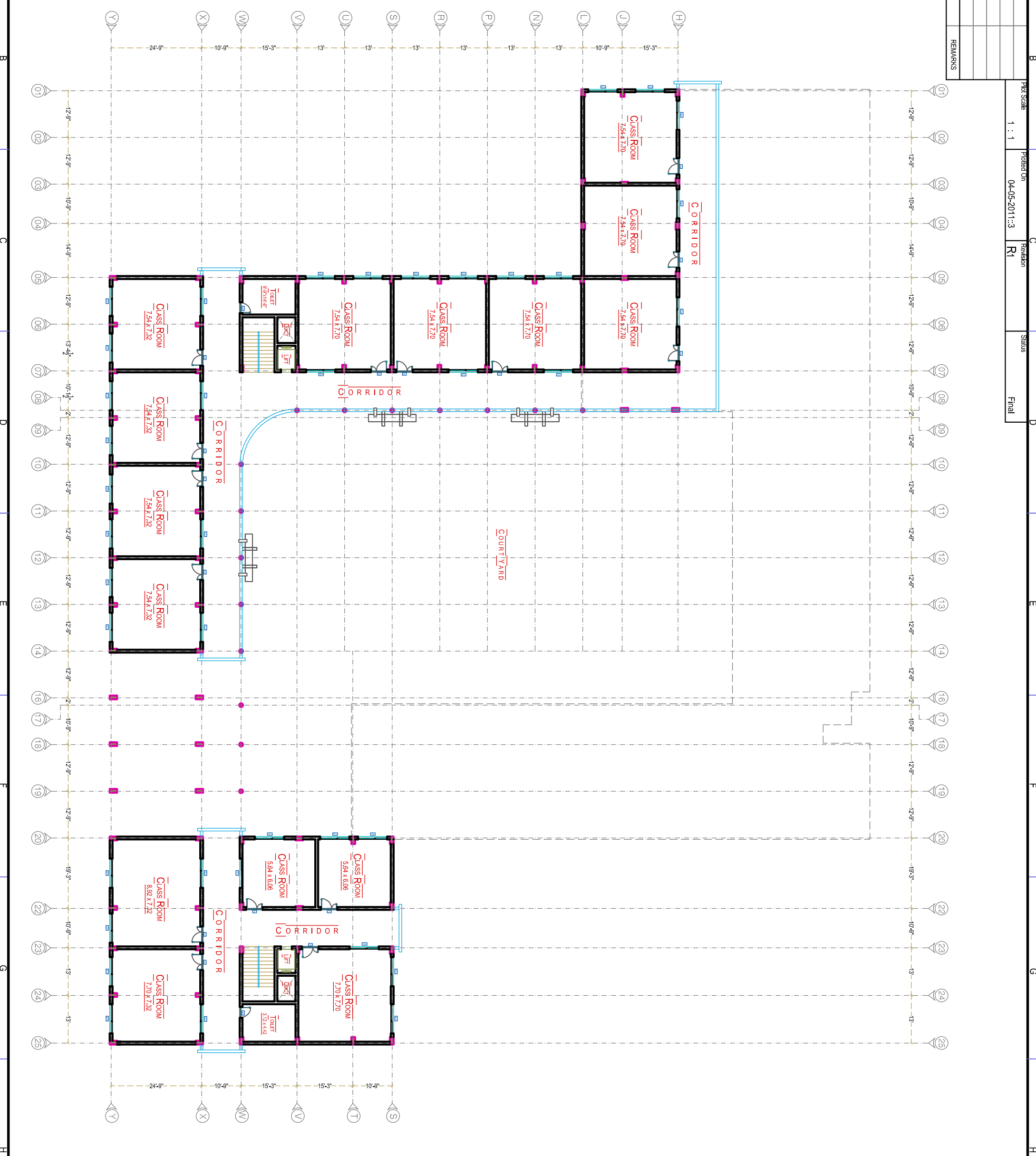

02

SHEET NO

This is only typical drawing for reference. Any modifications required/ altered/ enhanced in specifications/ tender document in accordance with this drawing for construction must take approval of EIC/ Employer/ Architect/ PMC Consultants before job commences. Contractor must verify drawings/ documents to execute the job within the PO Quantity. Please inform to consultants for any further information/ drawing/ detail/ specification required for faster execution of project.

First Floor Plan
 Azaan International School
 Snehta Hills,
 Peerancheruvu (V),
 Rajinder nagar (M), R.R Dist., A.P.

CLIENT
 Azaan International School

REFERENCE	REMARKS	APPD
Proposed	Urgent	Res-05/11
Existing	For Review	Subbu
To be removed	PL Comment	CS Rao
Included	Reply ASAP	As Shown
Future		
Good For	CAD File Name:	

TRUST



05.11